

Key: Mogul
Door: Swinging
Security Level: Minimum/Medium

D9300 MAXI-MORTISE™

Description

Series D9300 locks are pin tumbler mortise locks for swinging doors.

Applications

An extra heavy-duty mortise lock for use on swinging doors in minimum/medium security cell or public areas of detention facilities. Available in a variety of latchbolt, deadbolt and deadlocking latchbolt styles.

Standards Compliance

UL10B listed as Fire Door Accessory, 4 hour rating.

UL437 Listed Cylinder

ASTM F-1577 Grade 1 – Impact

Standard Features

- **Fits ANSI door preparation** – Standardized installation in hollow metal doors modified to accommodate lock body thickness of 1-1/8".
- **Door thickness** – Doors must be 1-3/4" to 2-1/2" thick.
- **Armored front** – 8" x 1-1/4" steel, 10 gauge.
- **High strength case and cover** – 12 gauge.
- **Corrosion-resistant working parts** – Internal working parts are stainless steel or zinc chromated steel.
- **Durable hubs** – Solid stainless steel construction, on the square.
- **Spindle** – 11/32" cold drawn steel.



Shown without LeverTrak®

- **Latchbolt** – One-piece investment cast 17-4 stainless steel, hardened, 3/4" throw.
- **Deadbolt** – One-piece investment cast 17-4 stainless steel, hardened, 1" throw.
- **Latchbolt size** – 11/16" x 1-1/4".
- **Deadbolt size** – 11/16" x 1-1/2".
- **Reversible** – Locks are field reversible. Handing, if known, should be specified upon ordering.
- **Key cylinder** – Price includes mogul cylinder.
- **Screws** – Tamper-resistant mounting screws.
- **Tamper-resistant** – All bolts, including the auxiliary latchbolt, are fully tunneled to help prevent jamming of the mechanism with foreign material.
- **Strike** – Supplied with curved-lip strike having 1-1/4" lip length and dust box. Buffed stainless steel finish only.
- **Trim finish** – US32D (ANSI/BHMA 630).

Optional Features

- **Strike switch** – Strike-mounted indication switch for electrically monitored systems.
- **Cylinder** – Available with 110 Mogul or 190 Maxi-Mogul® key cylinder provides maximum pick-resistance and matches keying on your job. Maxi-Mogul® UL437, Level 1 listed.
- **ASSA or MEDECO Mogul cylinders** – Available to complement keying systems.

For more information, please call 210.533.1231.



Key: Mogul
Door: Swinging
Security Level: Minimum/Medium

D9300 MAXI-MORTISE™

Trim Designs

- **Knobs** – standard trim US26D.
 Specify KR for knob and rose trim with lock.
 Dimensions: 2-1/4" diameter.
 Safety knob: Specify "SK" knob and side installed on.
- **Lever handles** – all Lever handles must be installed with track.
 Material: Stainless steel.
 Dimensions: 3/4" diameter x 4-11/16" long.
- **Roses** –
 Material: Stainless steel.
 Dimensions: 2-11/16" diameter, concealed trim design.
- **LeverTrak® Handle Guide Sets** – LT and LTE Handle Guide Sets must be specified. The track prevents damage to mortise locks from over-travel of the handle.
 Material: Stainless steel.

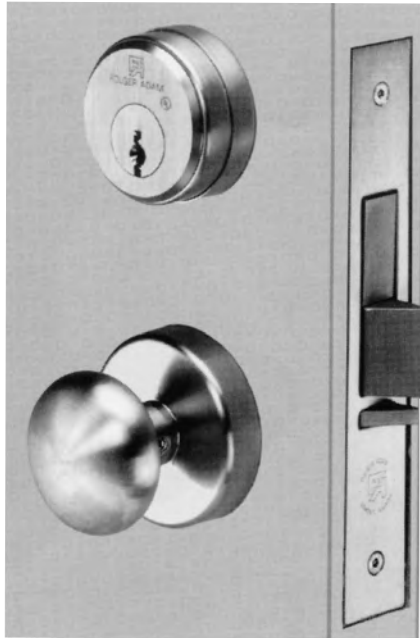

KR – Knob handle and rose



SK – Safety knob (inside)

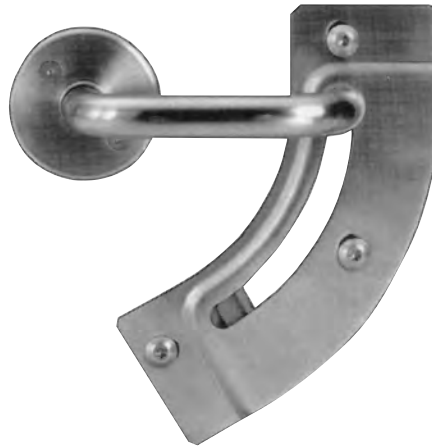

LT – Lever handles and track set
The "Lemont"

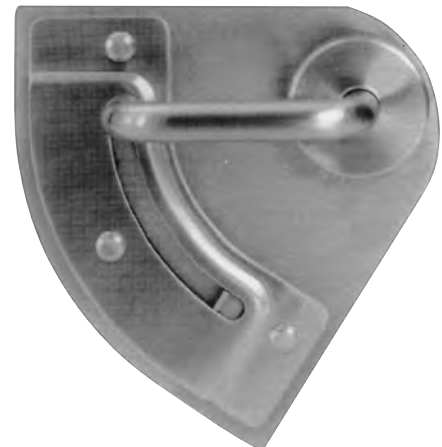

LTE – Lever handles, track set and escutcheon
The "Limited"



P.O. Box 2021, San Antonio, TX 78297 ■ Ph: 210.533.1231 ■ Fx: 210.533.2211
 Web: www.SouthernFolger.com ■ Email: info@southernfolger.com

Key: Mogul
Door: Swinging
Security Level: Minimum/Medium

D9300 MAXI-MORTISE™

D9300 Series Lock Functions

OUTSIDE	INSIDE	OUTSIDE	INSIDE
	<p>D9301 (F01) – Passage or closed latch</p> <ul style="list-style-type: none"> Either handle operates the latchbolt at all times. 		<p>D9314 (F14) – Store door lock</p> <ul style="list-style-type: none"> Latchbolt operated by handles either side. Deadbolt operated by key both sides.
	<p>D9304 (F04) – Entry lock</p> <ul style="list-style-type: none"> Latchbolt operated by handle either side except when outside handle is made inoperative by inside thumbturn. When outside handle is locked, latchbolt operated by key outside, handle inside. Auxiliary deadlatch. 		<p>D9335 (F15 Mod.) – Modified hotel guest lock</p> <ul style="list-style-type: none"> Latchbolt operated by handle inside, or by key outside. Deadbolt operated by thumbturn inside, or by key outside. Outside handle always inactive. Auxiliary deadlatch. <p>SHADED HANDLE DENOTES RIGID.</p>
	<p>D9305 (F05) – Classroom lock</p> <ul style="list-style-type: none"> Latchbolt operated by handle either side, except when outside handle is locked by key outside. Inside handle is always operative. Auxiliary deadlatch. 		<p>D9336 – Inmate keyed lock</p> <ul style="list-style-type: none"> LCK cylinder outside. LCK operates latchbolt only. Master key operates latch and deadbolt from outside. Outside handle always inactive. Auxiliary deadlatch. <p>SHADED HANDLE DENOTES RIGID.</p>
	<p>D9307 (F07) – Storeroom or closet lock</p> <ul style="list-style-type: none"> Latchbolt operated by key outside, handle inside. Outside handle inoperative at all times. Auxiliary deadlatch. <p>SHADED HANDLE DENOTES RIGID.</p>		<p>D9316 (F16) – Deadlock</p> <ul style="list-style-type: none"> Deadbolt is operated by key either side.
	<p>D9309 (F09) – Apartment, exit or toilet lock</p> <ul style="list-style-type: none"> Latchbolt operated by handle either side except when outside handle is locked by key from inside. When outside handle is locked, latchbolt is operated by key outside, handle inside. Auxiliary deadlatch. 		<p>D9317 (F17) – Deadlock</p> <ul style="list-style-type: none"> Deadbolt is operated by key outside, thumbturn inside.
	<p>D9313 (F13) – Dormitory or exit lock</p> <ul style="list-style-type: none"> Latchbolt operated by lever from either side. Deadbolt projected by key outside, and thumbturn inside. Both bolts retracted by inside lever. 		<p>D9318 (F18) – Deadlock</p> <ul style="list-style-type: none"> Deadbolt is operated by key from outside only.

For more information, please call 210.533.1231.



D9300 MAXI-MORTISE™

D9300 Series Lock Functions

OUTSIDE	INSIDE	OUTSIDE	INSIDE
	<p>D9319 (F19) – Privacy, bedroom or bath lock</p> <ul style="list-style-type: none"> ▪ Latchbolt operated by handle either side. ▪ Deadbolt operated by thumbturn inside, emergency release outside. ▪ Inside handle retracts both bolts. 		<p>D9372 – Deadlatch</p> <ul style="list-style-type: none"> ▪ Deadlatch operated by key both sides. ▪ Auxiliary deadlatch. <p>SHADED HANDLE DENOTES RIGID.</p>
	<p>D9320 (F20) – Apartment corridor door lock</p> <ul style="list-style-type: none"> ▪ Latchbolt operated by lever either side, except when deadbolt is projected. ▪ Deadbolt operated by key outside or thumbturn inside. ▪ Key operates both bolts. ▪ Lever inside retracts both bolts. ▪ Latchbolt is deadlocked when deadbolt is projected. ▪ When deadbolt is retracted, lever is unlocked. 		<p>D9373 – Deadlatch</p> <ul style="list-style-type: none"> ▪ Deadlatch operated by key outside, handle inside. ▪ Auxiliary deadlatch.
			<p>D9374 – Deadlatch</p> <ul style="list-style-type: none"> ▪ Deadlatch operated by handle or knob inside. Outside handle rigid. ▪ Auxiliary deadlatch. <p>SHADED HANDLE DENOTES RIGID.</p>
	<p>D9321 (F21) – Entrance or storeroom door lock</p> <ul style="list-style-type: none"> ▪ Latchbolt is operated by handle either side. ▪ Deadbolt operated by key outside, thumbturn inside. 		<p>D9375 – Deadlatch</p> <ul style="list-style-type: none"> ▪ Deadlatch operated by key outside. ▪ Key locks inside handle. Outside handle rigid. ▪ Auxiliary deadlatch. <p>SHADED HANDLE DENOTES RIGID.</p>
	<p>DLT-20FF Dummy trim for single or pairs of doors</p> <ul style="list-style-type: none"> ▪ Push or pull only. ▪ Handles rigid at all times, trim not operational. ▪ Full dummy trim, through-bolted. <p>Not Available</p>		<p>D9376 – Deadlatch</p> <ul style="list-style-type: none"> ▪ Deadlatch operated by key both sides. ▪ Key locks inside handle. Outside handle rigid. ▪ Auxiliary deadlatch. <p>SHADED HANDLE DENOTES RIGID.</p>
	<p>D9371 – Deadlatch</p> <ul style="list-style-type: none"> ▪ Deadlatch operated by key outside. ▪ Auxiliary deadlatch. <p>SHADED HANDLE DENOTES RIGID.</p>		<p>D9377 – Deadlatch</p> <ul style="list-style-type: none"> ▪ Deadlatch operated by key outside. ▪ Key locks both handles. ▪ Auxiliary deadlatch.



Key: Mogul
Door: Swinging
Security Level: Minimum/Medium

D9300 MAXI-MORTISE™

D9300 Series Lock Functions

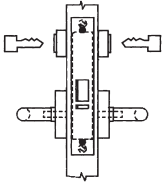
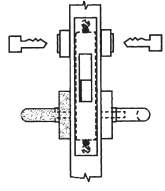
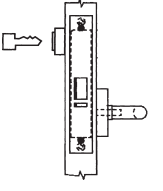
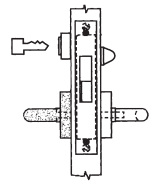
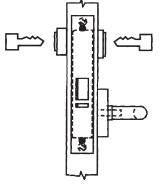
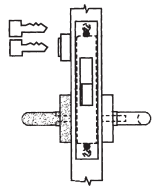
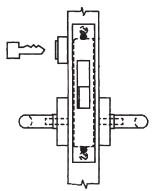
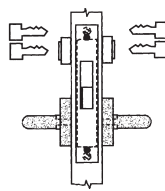
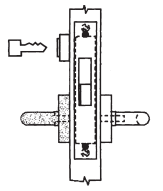
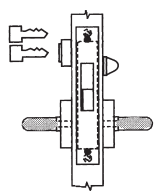
<p>OUTSIDE INSIDE</p>  <p>D9378 – Deadlatch</p> <ul style="list-style-type: none"> Deadlatch operated by key both sides. Key locks both handles. Auxiliary deadlatch. 	<p>OUTSIDE INSIDE</p>  <p>D9363 – Latch and Deadbolt</p> <ul style="list-style-type: none"> Deadbolt operated by key both sides. Latch operated by inside handle. <p>SHADED HANDLE DENOTES RIGID.</p>
 <p>D9379 – Deadlatch</p> <ul style="list-style-type: none"> Deadlatch operated by key outside. Key locks inside handle. No outside handle. Auxiliary deadlatch. 	 <p>D9364 – Latch and Deadbolt</p> <ul style="list-style-type: none"> Deadbolt operated by key outside. Deadbolt operated by thumbturn inside. Latch operated by inside handle. <p>SHADED HANDLE DENOTES RIGID.</p>
 <p>D9380 – Deadlatch</p> <ul style="list-style-type: none"> Deadlatch operated by key both sides. Key locks inside handle. No outside handle. Auxiliary deadlatch. 	 <p>D9365 – Latch and Deadbolt</p> <ul style="list-style-type: none"> Deadbolt operated by key and LCK* cylinder outside. Latch operated by inside handle. <p>SHADED HANDLE DENOTES RIGID.</p>
 <p>D9361 – Latch and Deadbolt</p> <ul style="list-style-type: none"> Deadbolt operated by key outside. Latch operated by both handles. 	 <p>D9366 – Latch and Deadbolt</p> <ul style="list-style-type: none"> Deadbolt and latch operated by key and LCK* cylinder both sides. <p>SHADED HANDLE DENOTES RIGID.</p>
 <p>D9362 – Latch and Deadbolt</p> <ul style="list-style-type: none"> Deadbolt operated by key outside. Latch operated by inside handle. <p>SHADED HANDLE DENOTES RIGID.</p>	 <p>D9367 – Latch and Deadbolt</p> <ul style="list-style-type: none"> Deadbolt and latch operated by key and LCK* cylinder outside. Deadbolt and latch operated by thumbturn inside. <p>SHADED HANDLE DENOTES RIGID.</p>

*LCK - Limited Control Key used by inmate. See next page for more information.

For more information, please call 210.533.1231.



Key: Mogul
Door: Swinging
Security Level: Minimum/Medium

D9300 MAXI-MORTISE™

Cylinder Data

- **Maxi-Mogul® key cylinders** – D9300 Series Mortise Locks are provided with Maxi-Mogul® key Cylinders, six pin tumbler. Keys are sold separately and registered at the factory.
- **Cylinder collar** – An adjustable cylinder collar will be provided to suit the cylinder length and door thickness when both locks and cylinders are ordered. If not specified, rings will be for 1-3/4" thick doors.
- **Trim / cylinder accessories** – The following trim items will be provided per the lock function specified.
- **LCK (limited control key)** – Modification for Models D9336, D9365, D9366, D9367. Factory provided cylinder is modified to allow change key a limited rotation to retract the latchbolt. Master key is unlimited and will operate both latch and deadbolt.
- **Thumbturn and escutcheon** – Furnished with Models D9304, D9313, D9317, D9320, D9321, D9335, D9364 and D9367.

Removable thumbturn furnished with Model D9319.

Supplied with tamper-resistant No. 6 x 3/8" screws.



Maxi-Mogul® Key Cylinder

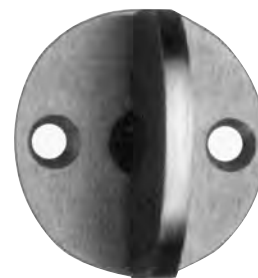

Thumbturn with Escutcheon



Maxi-Mogul® Key



Key: Mogul
Door: Swinging
Security Level: Minimum/Medium

D9300 MAXI-MORTISE™

Strikes

D9300 Series Locks are supplied with a curved lip strike having a 1-1/4" lip length for use with doors 1-3/4" to 2" thick. Buffed stainless steel finish only.

- **Strike with indication switch** – For electric monitoring.
- **Strike box** – Wrought steel, zinc plated, reversible for installation with flat or curved-lip strike.
- **Special lip lengths** – Strikes are installed 3/8" above the vertical centerline of the lock. 1-1/4" lip length is standard. 1-1/2" lip length is optional for doors from 2-1/8" to 2-1/4" thick.

Handing

Handing of locks should be indicated when ordering. Guidelines shown on page C46 will assist in determining the hand. Door must be addressed from the key side, the cylinder side or the secured side.

How to Order

Specify:

- 1) Trim
 - a. KR, Knob and rose set. (Safety knob available "SK", specify side).
 - b. LT, LeverTrak® Guide with handle and rose.
 - c. LTE, LeverTrak® Guide with handle, rose and escutcheon.
- 2) Lock Model D93__.
- 3) Function (see function descriptions) D9309.

4) Handing (RH, LH, RHR, LHR)

5) Cylinder

- a. With cylinder(s)
- b. Less cylinder(s)

6) Door material/thickness

7) Strike lip length

- 918 – 1-1/4" lip(s)
- 914 – 1-1/2" lip(s)

8) Strike switch(es), if required

EXAMPLE:

LT-D9309 LH Less cyl. 2"HM x 918-L

The above is a public entrance lock with LeverTrak® Handle Guide, left hand, for use with customer-supplied cylinder, on a 2" hollow metal door, equipped with strike-mounted switch.



918-D-S
Strike switch



918-L ANSI
Latchbolt-only
strike
RH/LHR shown

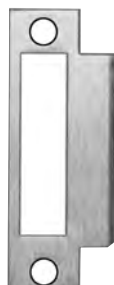

918-LD ANSI
Latchbolt/
deadbolt
strike
RH/LHR shown



918-D ANSI
Deadbolt strike
RH/LHR shown



918-DNL
Deadbolt strike
without lip



900-BOX
Dust box

For more information, please call 210.533.1231.



D9300 MAXI-MORTISE™

Dimensional Data

Note: Dimensions are for information and planning purposes only, and should not be used as templates.

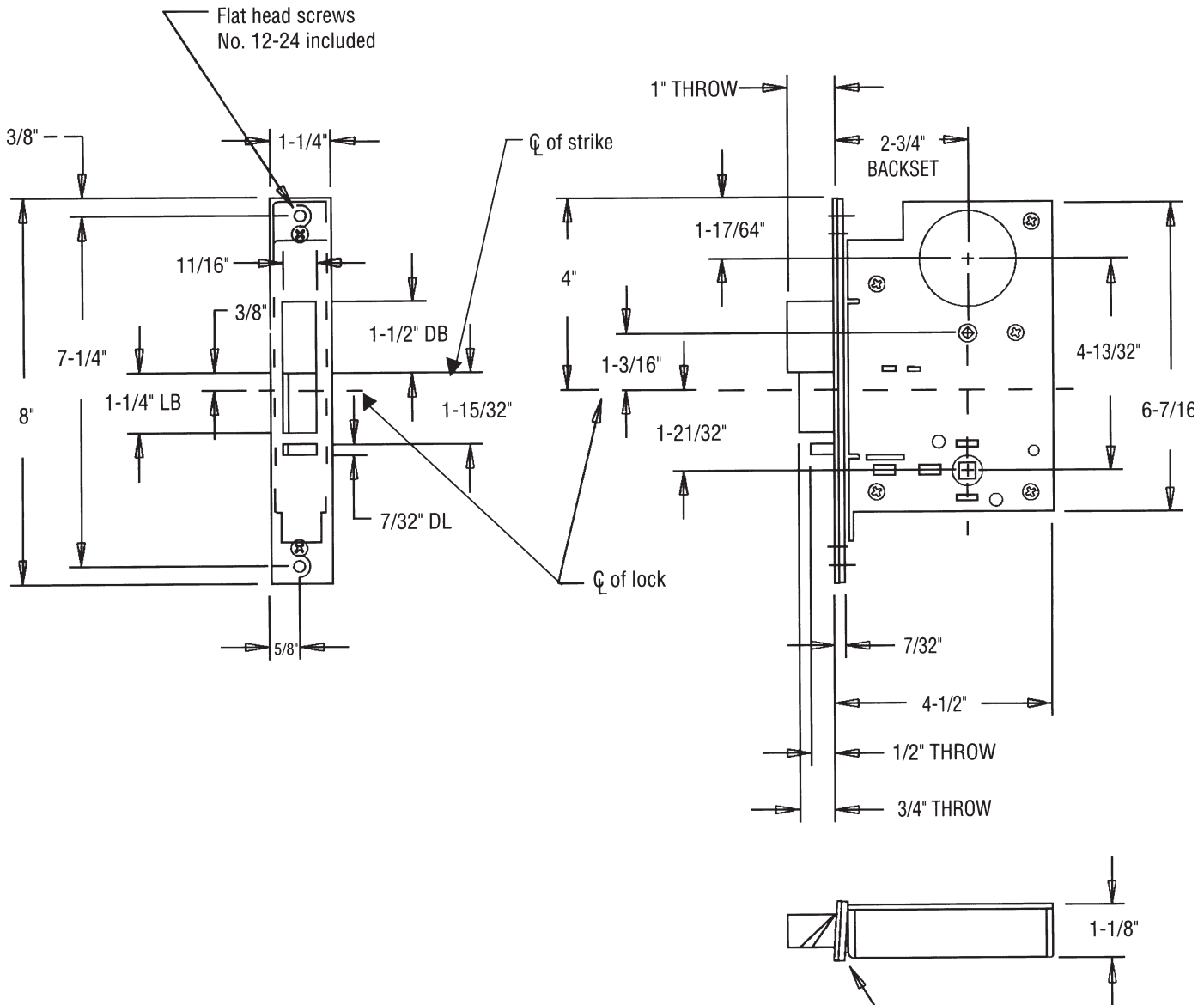

Bevel 1/8" on 2". Shims between armor plate and lock case may be reversed to match door bevel.

