



PNEUMATIC LOCK APPLICATION GUIDELINES

51P Deadlatches—Used on heavy traffic, high security swinging cell, corridor, vestibule or entrance doors.

120P Deadlatches—Used on swinging doors for cell, corridors or entrances.

120P Deadlatch—Used on swinging corridor or vestibule doors left open for extended periods.

NS400P Deadlatch—Used for minimum security or direct-supervision swinging cell doors, office or administrative areas, or corridor doors under supervision.

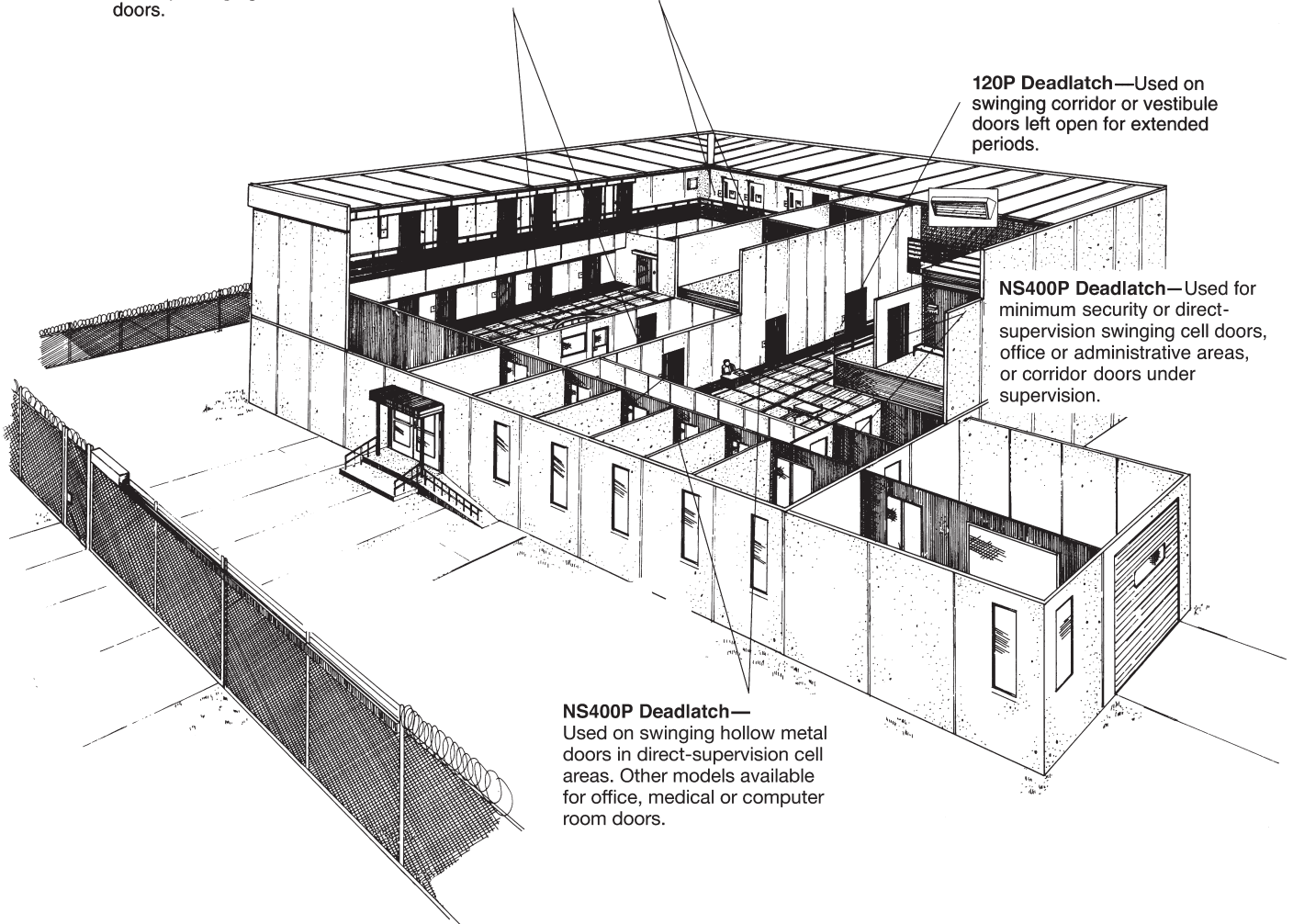

NS400P Deadlatch—Used on swinging hollow metal doors in direct-supervision cell areas. Other models available for office, medical or computer room doors.

IMPORTANT NOTE: The above guidelines are not specific recommendations. The security of a particular door or group of doors depends upon not only hardware employed, but also supervision both direct and indirect. For questions on the application of a particular lock, contact the factory.

For more information, please call 210.533.1231.





PNEUMATIC LOCK SELECTION GUIDE AND SECTION INDEX

LOCK TYPE	CYLINDER TYPE	DOOR TYPE	APPLICABLE SERIES	SECURITY LEVEL	PAGE
Deadlatch	Pin tumbler (Builders Hardware Cyl.)	Swinging	NS400P	Min/Med	B5-B6
Deadlatch	Pin tumbler (Mogul Cyl.)	Swinging	120P	Med/Max	B7-B8
Deadlatch	Lever tumbler	Swinging	51P	Maximum	B9-B10

The above is a generalized guideline only. To determine specific models required for your application, refer to product pages for detailed descriptions.

