

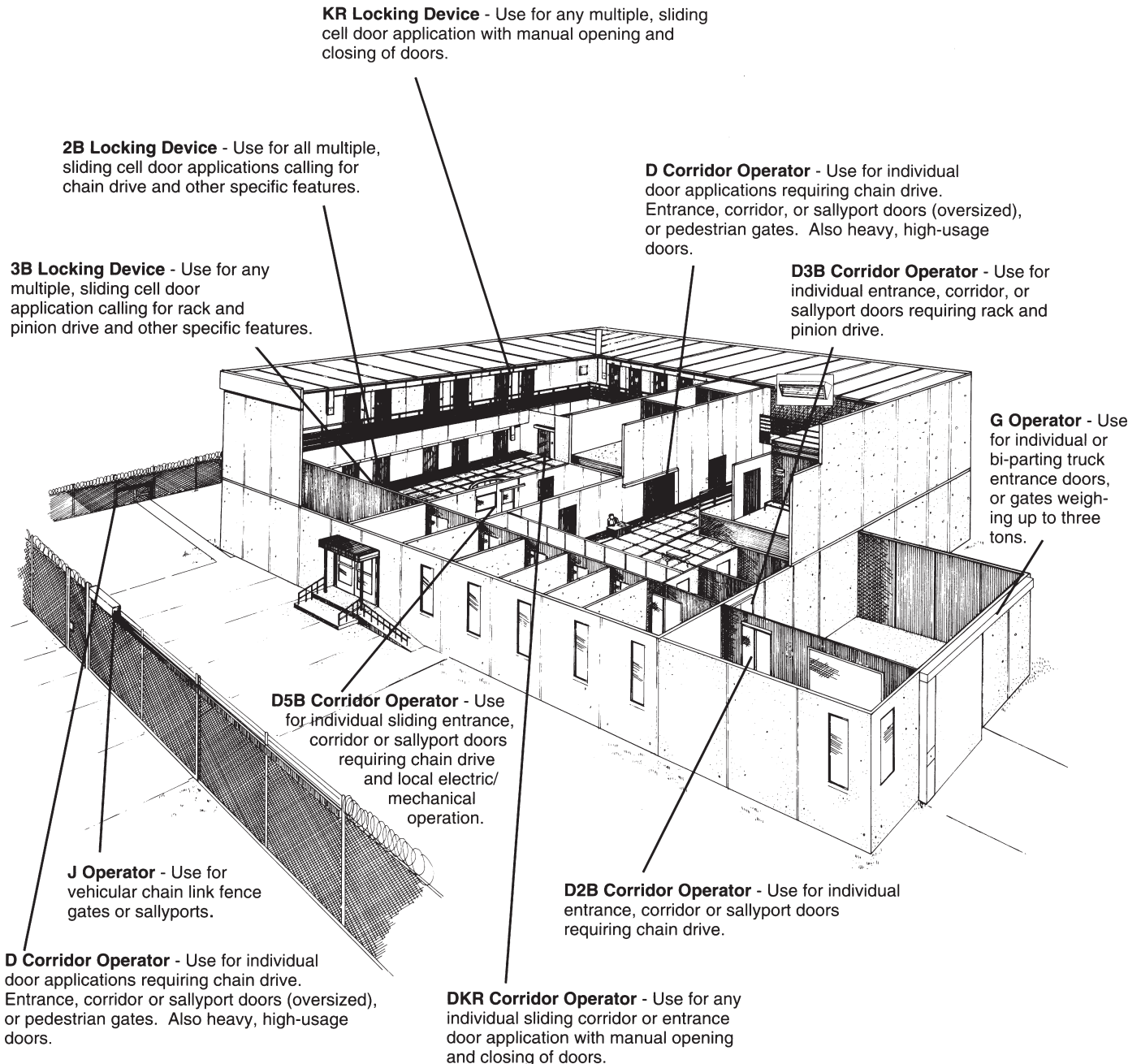

LOCKING DEVICE/DOOR OPERATOR APPLICATION GUIDELINES



IMPORTANT NOTE: The above are guidelines and not specific recommendations. The security of a particular door or group of doors depends upon not only hardware employed, but also supervision both direct and indirect. For questions on application of a particular lock, contact the Southern Folger Marketing Department or your Regional Manager.

For more information, please call 210.533.1231.





LOCKING DEVICE APPLICATION GUIDELINES

Installation Overview

The purpose of this section is to provide an outline of the considerations involved in specifying a locking device. Complete installation information is issued on a per-job basis, so that the installer is able to perform efficiently. The data presented here is intended to assist the specifier in defining product functions for preparing specifications for locking device systems.

Electrical Wiring

Provision should be made for conduit connections to locking devices and operators, whether for interior or exterior application. All devices are shipped with motors and switches factory wired to a terminal strip. Additional field wiring may be required. The custom nature of locking device systems – number of doors, length of run, number of units, etc. – precludes total pre-wiring at the factory. Optional cell line cable is available, which provides simplified connection of the

device drive system to the emergency release cabinet or as specified.

Devices recommended for indoor cells are provided with an internal wiring tray. This tray provides a routing path for wire and helps to keep wires away from the drive system of the device.

Physical Installation

A locking device is shipped from the factory in component assemblies for erection within the facility. A typical locking device consists of a mechanism housing, vertical lock column, door receiver, door hanger, door guide and guide angle, and control cabinet. The list of components may vary depending upon the specific device ordered.

Hardware Interface

Other hardware will be needed to install the devices, which is not provided by Southern Folger. Doors, frames and embedded items, such as mounting angles, anchors and bolts (in the case of masonry walls) must be ordered to

allow attachment of the locking device or operator to the wall in accordance with our installation instructions. Coordination between the specifier of a locking device system and the factory is essential to ensure trouble-free installation. Consult with us early in the planning stages for assistance.

Southern Folger offers technical and design services to the specifier which are backed by over a century of experience in the detention equipment industry. For any question of application or operation of a specific device or operator, contact the factory for further information.

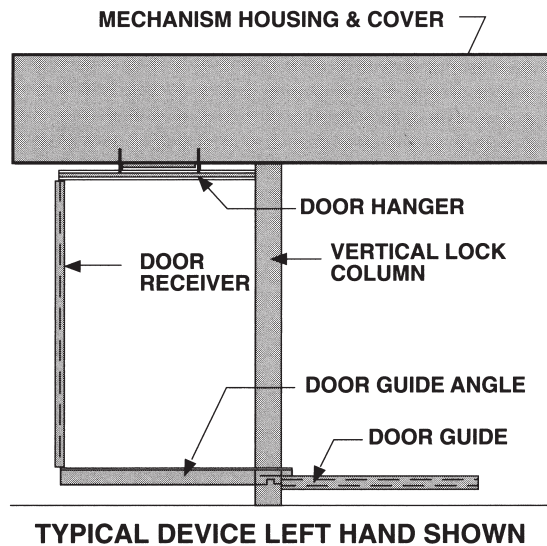



GUIDE TO SPECIFICATION PREPARATION

Considerations

1. Application
 - a. Multiple cell doors
 - b. Individual corridor door
2. Location of door(s)
 - a. Interior
 - b. Exterior
3. Overall number of doors to be controlled
4. Door model/size/weight
5. Wall type
 - a. Masonry
 - b. Concrete
 - c. Plate
6. Drive type
 - a. Chain
 - b. Rack and Pinion
 - c. Manual
7. Control required
 - a. Mechanical
 1. Mechanical at the door
 2. Mechanical remote gang unlocking
 - b. Electrical
 1. Electrical at the door
 2. Electrical remote
 3. Electrical inmate
 - c. Customized system
 - d. Control location
 1. Adjacent to door
 2. End of cell run
 3. Remote control room
8. Optional features required
 - a. Front release column
 - b. Key switch operation
 - c. Mechanical release system
 - d. Wire harness (2B, 3B, KR)
 - e. Deadlock-open feature (2B, KR, DKR)
 - f. Three light indication (2B, KR)

For more information, please call 210.533.1231.





LOCKING DEVICE SELECTION GUIDE AND SECTION INDEX

DOOR TYPE	DRIVE TYPE	RELEASE TYPE	SECURITY LEVEL	MODEL/ FEATURE	PAGE
Indoor cell or corridor	Manual	Mechanical	Maximum	102	D7-D8
Indoor/cell sliding	Roller Chain	Remote electric and mechanical	Maximum	2B.3 (2) (4)	D9-D11
Indoor/cell sliding	Rack & Pinion	Individual or gang	Maximum	3B.2 (2) (4)	D13-D15
Indoor/cell sliding	Manual	Individual or gang	Medium	KR.3 (1) (2) (4)	D17-D19
				Mechanical Control Cabinets	D21-D22
Indoor/corridor exterior gate sliding	Roller Chain	Remote electric local mechanical	Maximum	D (2) (3)	D23-D24
Indoor/corridor sliding	Roller Chain	Remote electric local mechanical	Maximum	D2B.3 (1) (2)	D25-D26
Indoor/corridor sliding	Rack & Pinion	Remote electric local mechanical	Maximum	D3B.2 (1) (2)	D27-D28
Indoor/corridor sliding	Roller Chain	Remote electric local electric and local mechanical	Maximum	D5B (2) (3)	D29-D30
Indoor/corridor sliding	Manual	Remote electric local mechanical	Medium/ Maximum	DKR.3 (2) (3)	D31-D32
Exterior/entry door/gate sliding	Roller Chain	Remote electric local mechanical	Maximum Maximum	G Bi-parting G (3)	D33-D34
Exterior/vehicle sliding	Roller Chain	Remote electric local mechanical	Medium	J (3)	D35-D36

Feature (1) Optional Front Column. (2) Deadlocks at two concealed points at the rear edge of the door. Locking components are not exposed at the front edge of the door and, therefore, not subject to tampering. (3) Standard Front Column provided. (4) Normally used in conjunction with a mechanical control cabinet.

The above is a general guideline. To determine specific models required for your application, refer to product pages for detailed descriptions.



P.O. Box 2021, San Antonio, TX 78297 ■ Ph: 210.533.1231 ■ Fx: 210.533.2211
Web: www.SouthernFolger.com ■ Email: info@southernfolger.com